

STRUCTURAL NOTES

Please refer to all other design drawings by others. Please refer to drg. no. 1088/300 for specification and notes relating to structural engineering designs.

Blockwork strengths to be as follows: -

From top of foundation to u/s of 1st floor - 7.3N/mm² From 1st floor and above - 3.5 or 5N/mm²

STRUCTURAL KEY

- Span direction of infill members. MJ Movement joint in brickwork only (movement joints in blockwork by supplier). IL Internal box lintels. EL External cavity lintels. 7.3N/mm² strength blockwork. 3.5N/mm² or 5.0N/mm² strength blockwork. Engineering brickwork.

All lintels to be IG lintels of similar approved. Lintel sizes to be confirmed.

Padstones: PS1 = 100 x 225 x 150 Deep, PS2 = 100 x 330 x 225 Deep, PS3 = 100 x 555 x 300 Deep, PS4 = 100 x 450 x 330 x 375 Deep L-Shape. [All padstones to be Engineering Brick Class A & Mortar Designation (I)]

Timber Members: CR = Cut Rafter (47 x 200 Deep C24 @ 450mm c/c) CJ = Ceiling Joists (47 x 175 Deep C24 @ 600mm c/c)

Strapping: All First Floor joists and Roof structure to be strapped down to the face of masonry walls below in according to recommendation of Part A Building Regulations and NHBC Standards.

Ground Floor Window Lintel Schedule

Table with 4 columns: Number, Structural Opening, Length, Member Type. Lists lintels P3GF1 to P4GF4.

Ground Floor Doors Lintel Schedule

Table with 4 columns: Number, Structural Opening, Length, Member Type. Lists door lintels P3GFD1 to P4GFD4.

First Floor Window Lintel Schedule

Table with 4 columns: Number, Structural Opening, Length, Member Type. Lists first floor window lintels P3FF1 to P4FF7.

Second Floor Window Lintel Schedule

Table with 4 columns: Number, Structural Opening, Length, Member Type. Lists second floor window lintels P3FW1 to P4FW2.

Internal Lintel Schedule

Table with 4 columns: Number, Structural Opening, Length, Member Type. Lists internal lintels P3IFL1 to P4IFL1.

Rev Amendment table with columns: Rev, Amendment, By, Date. Lists P1, P2, A.

Ground Floor Steel Beams Schedule

Table with 4 columns: Number, Style, Opening, Length, Notes. Lists ground floor beams B2(P3) and B2(P4).

First Floor Steel Beams Schedule

Table with 4 columns: Number, Style, Length, Notes. Lists first floor beams B1(P3) and B1(P4).

GROUND FLOOR - PLOTS 3 & 4 (SHOWING STRUCTURE ABOVE)

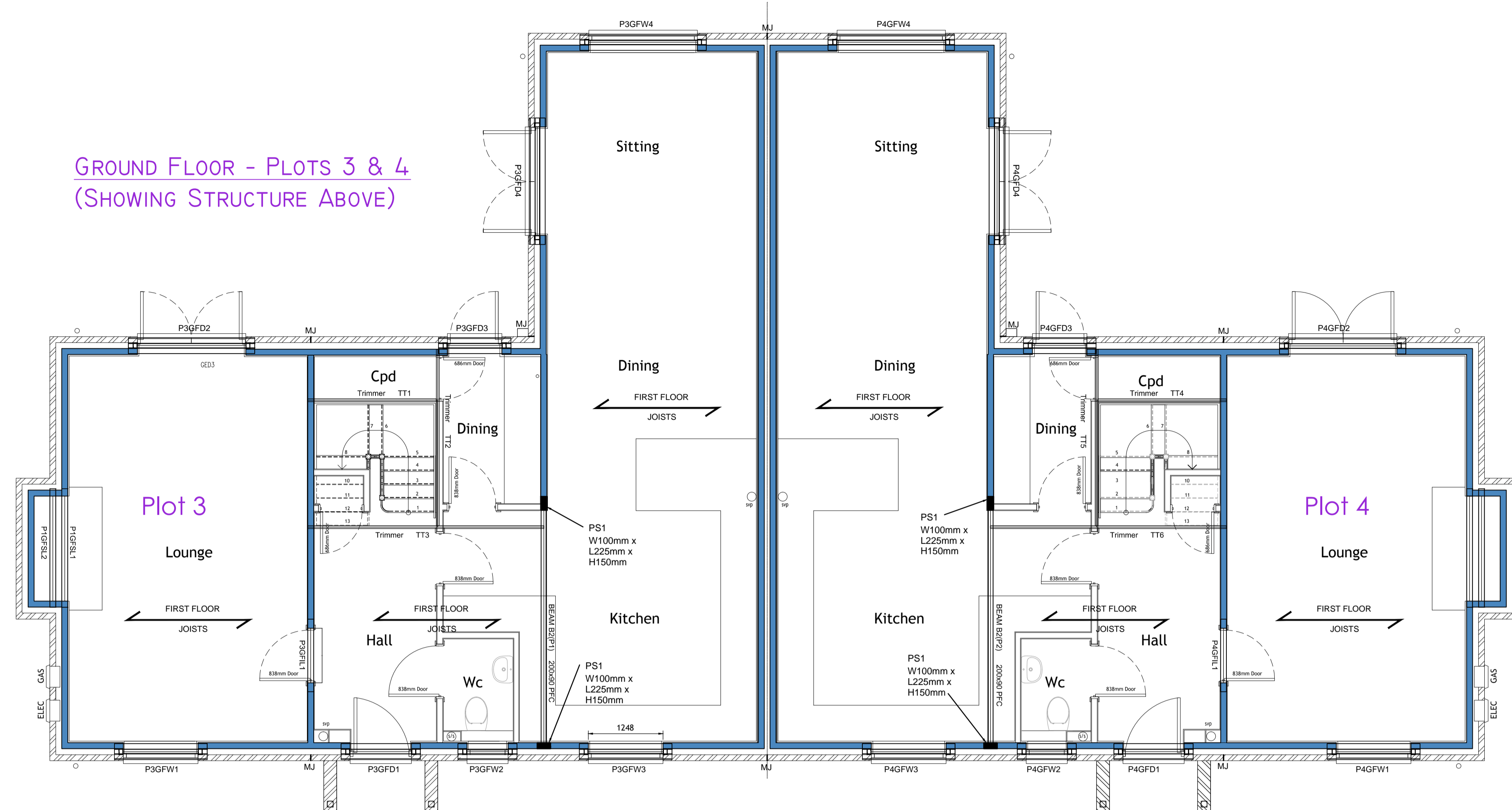

FIRST FLOOR - PLOTS 3 & 4 (SHOWING STRUCTURE ABOVE)

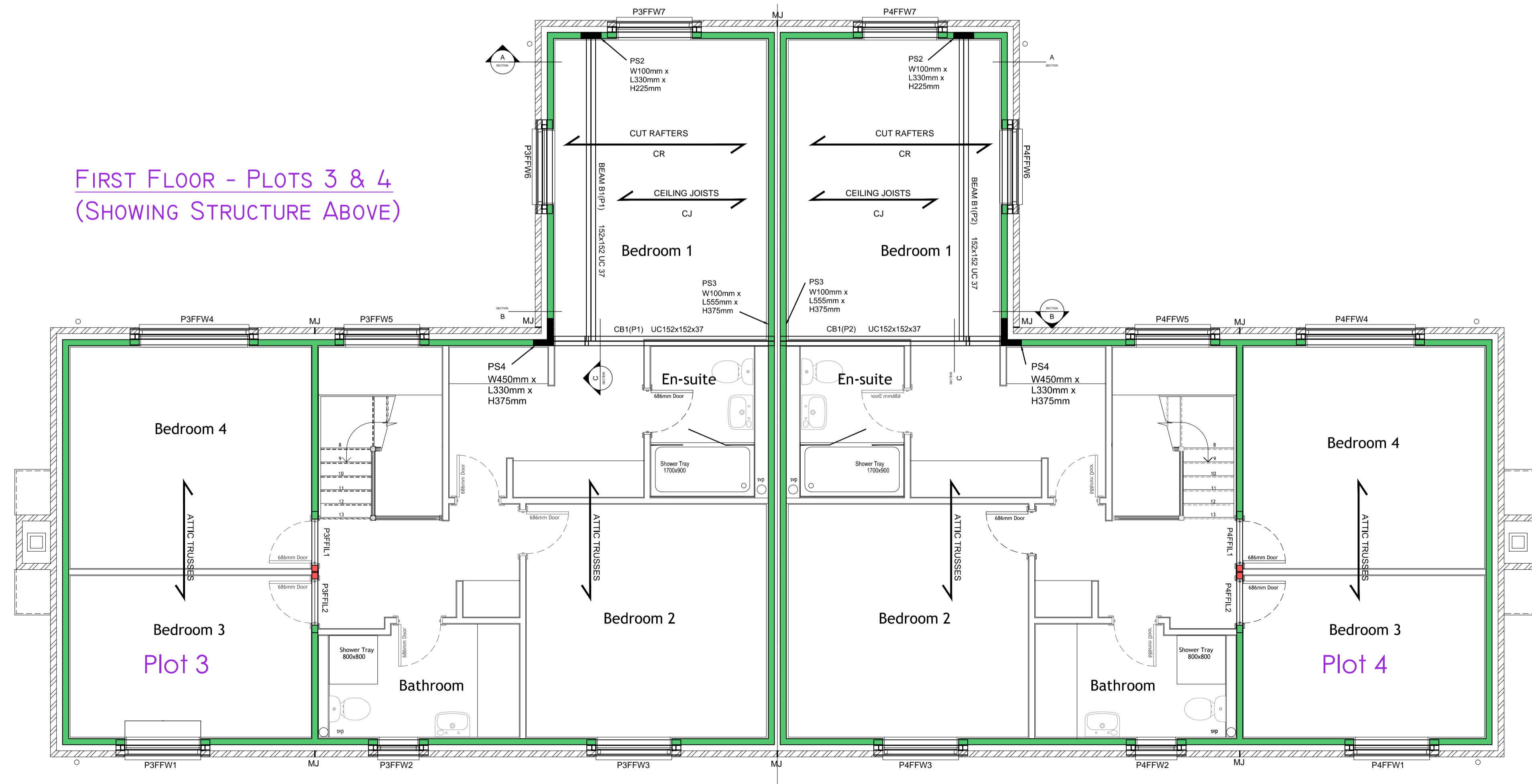

Suite 116, Milton Keynes Business Centre, Foxhunter Drive, Linford Wood, Milton Keynes, MK14 6GD. T: 01582 764100 F: 01582 764100 www.cistec.net e: info@cistec.net

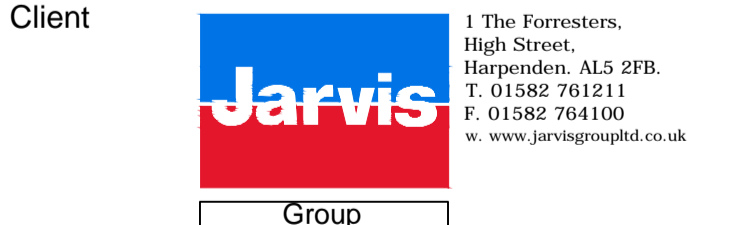

Client: Jarvis Group. Drawing: STRUCTURAL ENGINEERING Proposed Superstructure For Plots 3 & 4 Above Ground & First Floors. Project: Six Tunnel Farm, Gaddesden Row, Hemel Hempstead. Scale: 1:50 @ A1. Date: 17.10.11. Approved: AA. Drawing no: 1183 - 304 A

STATUS: CONSTRUCTION

This document and design remains the copyright of CISTEC Design LLP unless and until agreement is made in writing. No information may be copied, distributed or changed in any form without prior written consent.