

GENERAL NOTES

THIS DRAWING SHOULD BE READ IN CONJUNCTION WITH ALL OTHER DRAWINGS BY CISTEC AND DRAWINGS BY ARCHITECTS.

ALL WORKING DIMENSIONS TO BE CHECKED ON SITE.

DO NOT SCALE.

ANY DISCREPANCIES BETWEEN DRAWINGS OF DIFFERENT SCALES AND BETWEEN DRAWINGS AND SPECIFICATION WHERE APPROPRIATE TO BE NOTIFIED TO THE ENGINEER FOR DECISION.

COPYRIGHT RESERVED. THIS DRAWING MAY ONLY BE USED FOR THE CLIENT AND LOCATION SPECIFIED IN THE TITLE BLOCK. IT MAY NOT BE COPIED OR DISCLOSED TO ANY THIRD PARTY WITHOUT THE PRIOR WRITTEN CONSENT OF CISTEC.

PRIOR TO ANY WORK BEING COMMENCED ON SITE. THE ENGINEER SHOULD BE CONTACTED REGARDING THE CURRENT STATUS OR REGULATORY TECHNICAL APPROVAL OF THIS DRAWING.

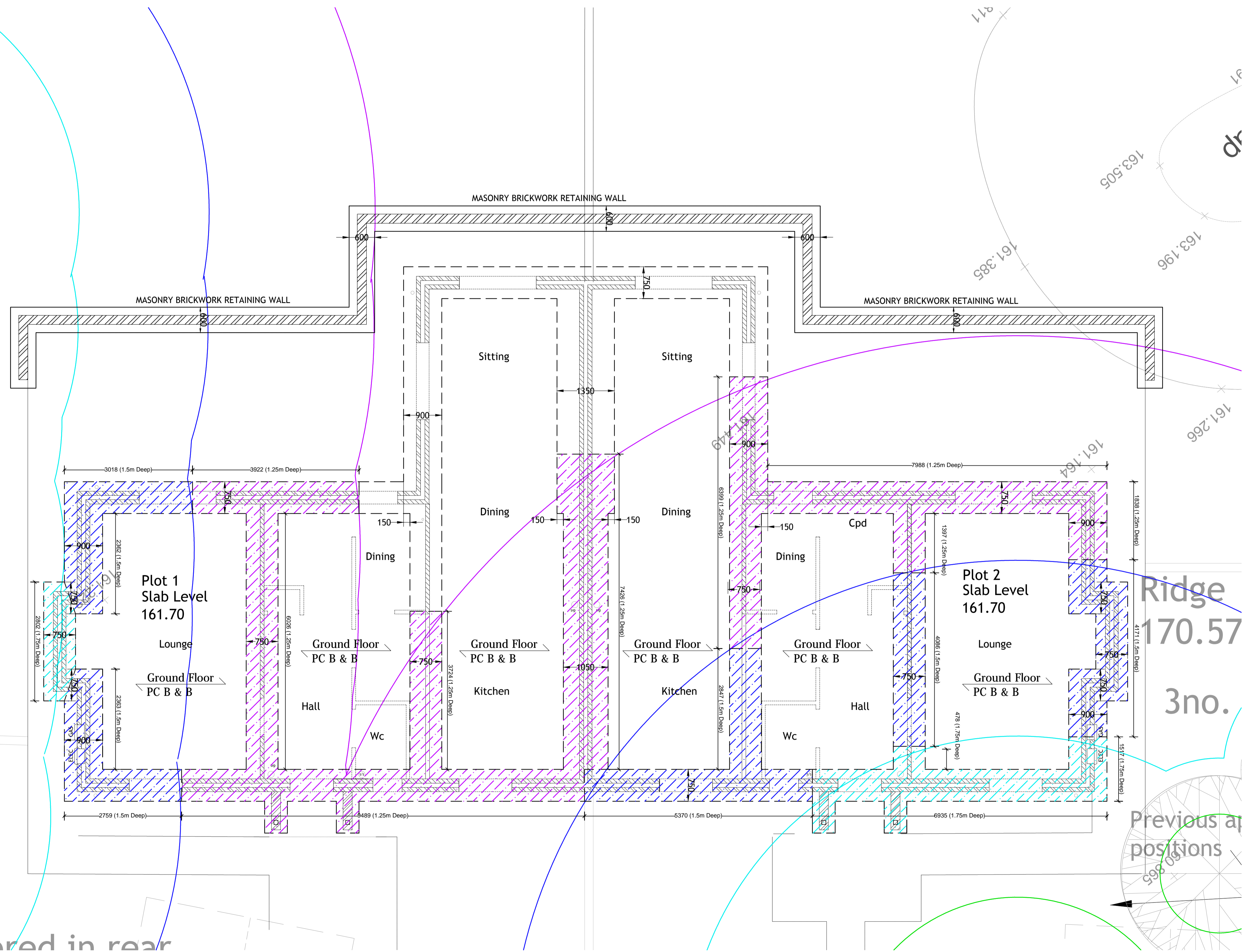

Rev	Amendment	By	Date
P1	First issue.	CST	20.07.12
P2	Entrance Porches Added & extent of Retaining Wall amended.	CST	06.08.12
A	Construction	CST	10.09.12

CISTEC
 CHARTERED CIVIL & STRUCTURAL ENGINEERING CONSULTANTS

Suite 116, Milton Keynes Business Centre, Foxhunter Drive,
 Linford Wood, Milton Keynes, MK14 6GD.
 T. 01908 686855 F. 01908 410333 www.cistec.net e.info@cistec.net

Client **Jarvis Group**
 1 The Forresters,
 High Street,
 Harpenden, AL5 2FB,
 T. 01582 761211
 F. 01582 764100
 www.jarvisgrouppld.co.uk

Drawing **STRUCTURAL ENGINEERING**
 Ground Floor & Foundation Layout
 Plots 1 & 2
 Project **Six Tunnels Farm, Gaddesden Row, Hemel Hempstead**
 Scale as noted @ A1 Date July 2012 Approved AA
 Drawing no. **1183 - 301 A**

PLOTS 1 & 2 - FOUNDATIONS & GROUND FLOOR SPANS

STATUS: CONSTRUCTION

© The enclosed drawing and design remains the copyright of CISTEC Design LLP unless or until agreement is made in writing. This information may not be copied, distributed or changed in any form without prior written consent.