

**General Notes**

Do not scale off this drawing unless a scale bar is provided.

Any ambiguities, omissions and errors on this drawing should be notified immediately to the Architect before the commencement of works on site.

All dimensions are in millimetres unless otherwise stated.

All dimensions, unless otherwise indicated, are to the face of unfinished block walls or to the rough timber face of stud partitions.

All dimensions are to be checked on site. Any discrepancies are to be notified immediately to the Architect before the commencement of works on site.

All levels are in meters unless otherwise stated.

This drawing is to be read in conjunction with all other relevant drawings and specifications for this project.

**Setting Out Notes:**

Setting out drawings to be read in conjunction with other relevant design drawings.

Grid dimensions set out to the following:  
 the outside face of external wall brick/blockwork.  
 Unless otherwise indicated on drawing.

All internal dimensions are to face of timber stud/blockwork.

Final location of rwp's to be determined subject to rainwater calculation.

Locations of movement joints (MJ) subject to confirmation by structural engineer. Note blockwork may require additional bed joint re-inforcement. final specification and centres to be advised by structural engineer.

Rev	Description	By	Date
P1	First issue.	swf	28.12.10
P2	Structural engineering up-dated following further design checks. Minor internal layout changes made in accordance with client comments.	swf	21.09.11
P3	Structural engineering amended and up-dated following changes. Padstone details added.	swf	21.09.11
P4	Structural engineering amended and up-dated following changes. Padstone details added.	swf	16.12.11
P5	Structural connection detail and beam calculation references added. Missing Steels added to schedule.	swf	21.12.11

Steelwork Schedule			
Number	Member	Length	Notes
B6	UC203x203x46	4355mm	Ridge beam at high level (RB3).
B7	UB203x133x25	4165mm	Ridge beam at high level (RB1).
B8	UC152x152x23	3942.5mm	Ridge beam at high level (RB2).
B9	RHS100x100x5	1682.7mm	Post from beam at first floor level supporting ridge beam above.
B11	UC203x203x46	6235mm	Beam for floor joists (FB1).
B22	UC152x152x37	4827.5mm	Beam to support post and ridge beam above (FB2).
B32	203x102x23UB	2714.5mm	Cranked steel part of frame CB1.
B46	203x102x23UB	2714.5mm	Cranked steel part of frame CB2.
B47	203x102x23UB	2714.5mm	Cranked steel part of frame CB2.
B48	203x102x23UB	2714.5mm	Cranked steel part of frame CB2.

Door Schedule											
Number	Location	Leaf Size	Structural Opening		Lintel	Fire Rating	Glazing		Safety Glazing		Remarks
			Width	Height			Clear	Obscured	Toughened	Laminated	
D101	Master Bed	754	838	1981	--	--					--
D102	En-Suite	754	838	1981	--	--					--

Window Schedule - first floor										
Number	Location	Structural Opening		Cill Height	Escape Window	Glazing		Safety Glazing		Remarks
		Width	Height			Clear	Obscured	Toughened	Laminated	
W102	En-Suite	780	978	1760		✓				Velux - M04.
W103	Landing	780	978	1760		✓				Velux - M04.
W104	Master Bed	780	978	1000	✓	✓				Large gable window.
W105	Master Bed	3795	2471.9	70		✓			✓	Large gable window.
W106	Kitchen	3795	1802.8	300		✓			✓	Large gable window.

**Doors & Windows Notes**

All windows to have trickle vents achieving 8000mm<sup>2</sup> min. background ventilation.

All windows to bathrooms and WC's to have trickle vents achieving 5000mm<sup>2</sup> min. background ventilation and mechanical rapid ventilation.

Windows to be 'Low E' white uPVC double glazed with 16mm gap and filled with Argon gas to achieve a min. value of 1.6W/m<sup>2</sup>K.

Areas requiring toughened glass to BS6202.

Internal doors to bathrooms and WC's to have 10mm gap at bottom.

**CDM AWARE!**  
Steelwork.

**CDM AWARE!**  
Brickwork to chimney.

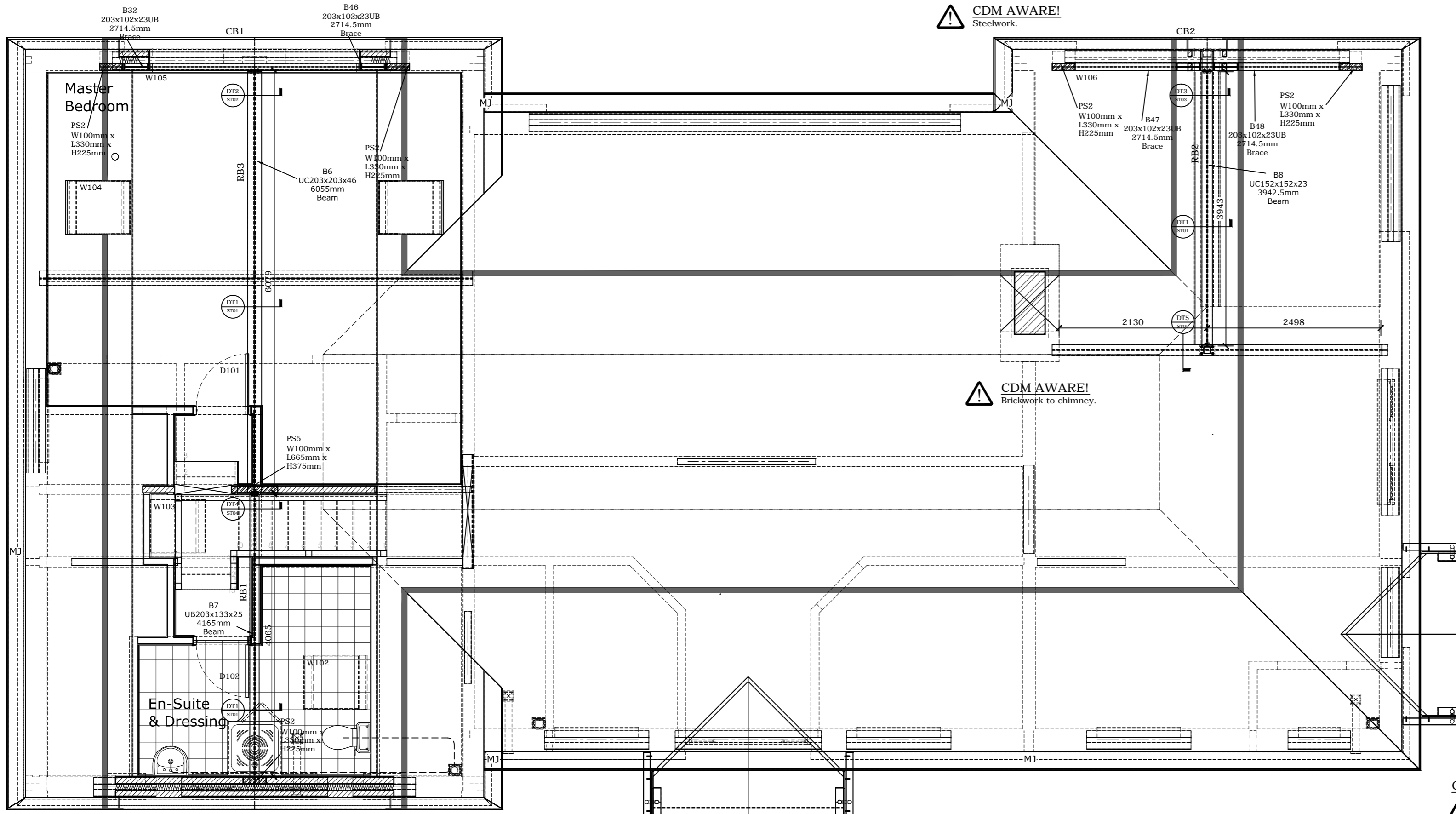

**CDM Regulations**

**CDM AWARE!** Denotes a significant Hazard or difficult to manage procedure. Please refer to Designer Hazard Register for further information regarding mitigation of hazards

Client	Mrs J Briton
Project	New Build Bungalow
Long Lane, Gambingay.	
Job	Working Drawings

Drawing Title	General Arrangements
First Floor	
Scale	1:50
Date	28.12.10
Project No./Discipline	1019-002
Drawn	SWF
Checked	AA
Drawing No.	P5
Revision	