

- ALL STEEL COLUMNS (WHERE POSSIBLE) ARE TIED TO ADJACENT MASONRY WALLS (WITH BRC BRICK-FORCE BED-JOINTS @ 225MM C/C'S VERTICALLY TO ACHIEVE A COMPOSITE STRUCTURAL EFFECT. PLEASE REFER TO DETAILS 1127-301.
- EL - EXTERNAL CAVITY WALL LINTEL (IG OR CATNIC)
 - IL - INTERNAL LINTEL
 - WP - IG WIND POSTS LP8 (170x70x6), WITH TOP CONNECTION TO US OF BEAMS/WALL PLATES AND BOTTOM CONNECTION TO STRUCTURAL FLOOR
 - MF - ASSUMED SPAN DIRECTION OF MEZZANINE FLOOR (POSSIBLE FUTURE)
 - FR - SPAN OF FLAT ROOF JOISTS (50x225MM DEEP C24 @ 450MM C/C'S)
 - CJ - SPAN OF CEILING JOISTS (60x200MM DEEP C24 @ 450MM C/C'S)
 - MJ - MOVEMENT JOINTS
 - BC - BRACING 75 X50 CHS WITHIN THE CEILING
 - TC - THERMAL CONNECTION PAD (BT OTHERS, FOR ALL EXTERNAL TO INTERNAL CONNECTIONS)
 - * - 150x90PFC FACING DOWN AT WINDOW CILL LEVEL

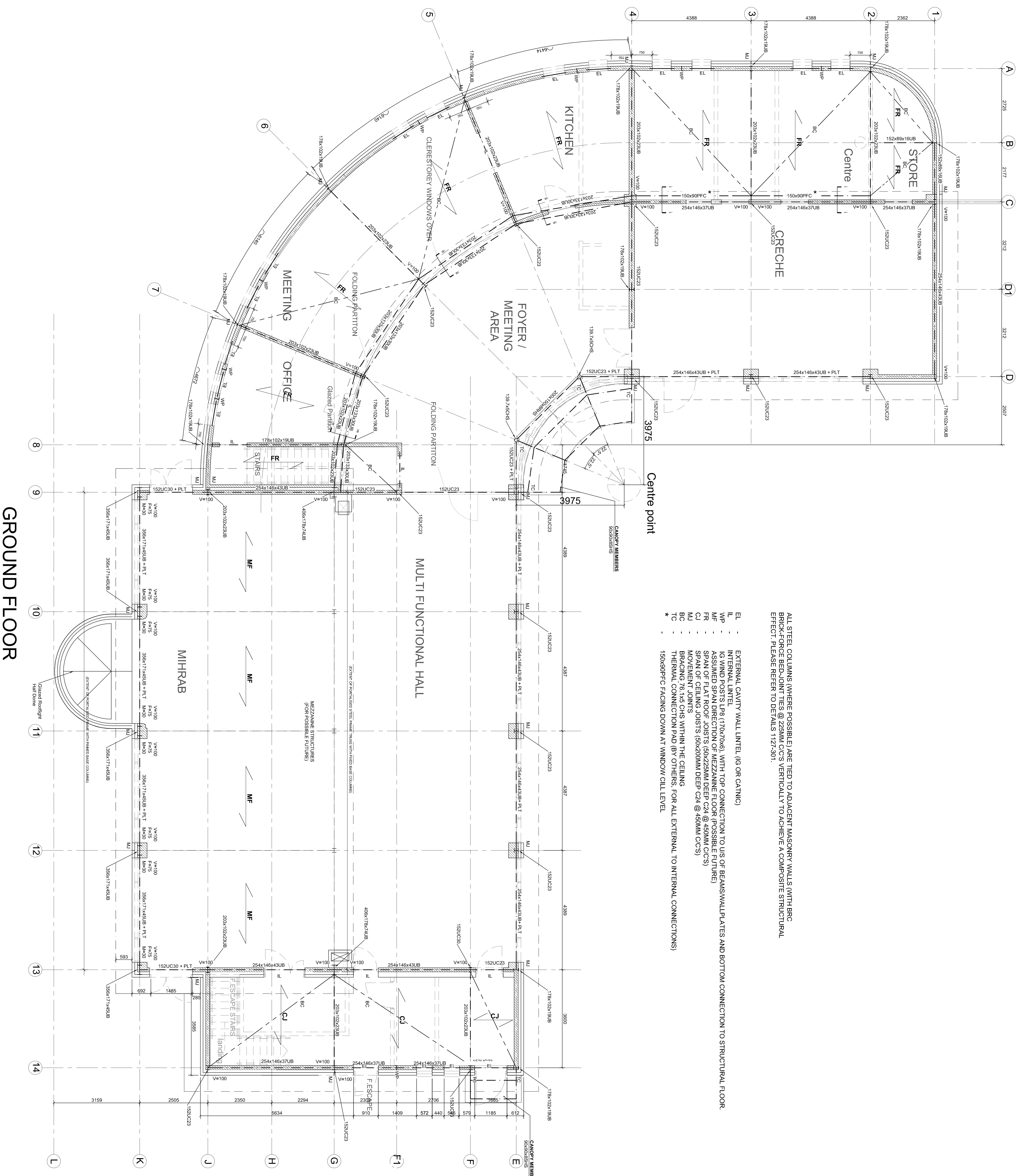

GROUND FLOOR

Rev	Amendment	By	Date
R1	Revised for construction	CS	15/12/23
R2	Revised for construction	CS	15/12/23
R3	Revised for construction	CS	15/12/23
R4	Revised for construction	CS	15/12/23
R5	Revised for construction	CS	15/12/23
R6	Revised for construction	CS	15/12/23
R7	Revised for construction	CS	15/12/23
R8	Revised for construction	CS	15/12/23
R9	Revised for construction	CS	15/12/23
R10	Revised for construction	CS	15/12/23

Client: SUN

Project: MIHRAB

Drawing: STRUCTURAL ENGINEERING Ground Floor

Project Manager: MUSA, Cedric Hill, Alison Keyne

Structural Engineer: (Title 2)

Scale: as shown @ 1:500

Date: 15/12/23

Approved: [Signature]

Checked: [Signature]

Drawn: [Signature]

1127-311 B

STATUS: CONSTRUCTION (SUBJECT TO BUILDING CONTROL APPROVAL).