

TYPICAL SECTION OF RC RAMP DOWN SLAB - LOADING BAY  
(Constructed sequentially in steps of 225mm deep, as shown on the plan)

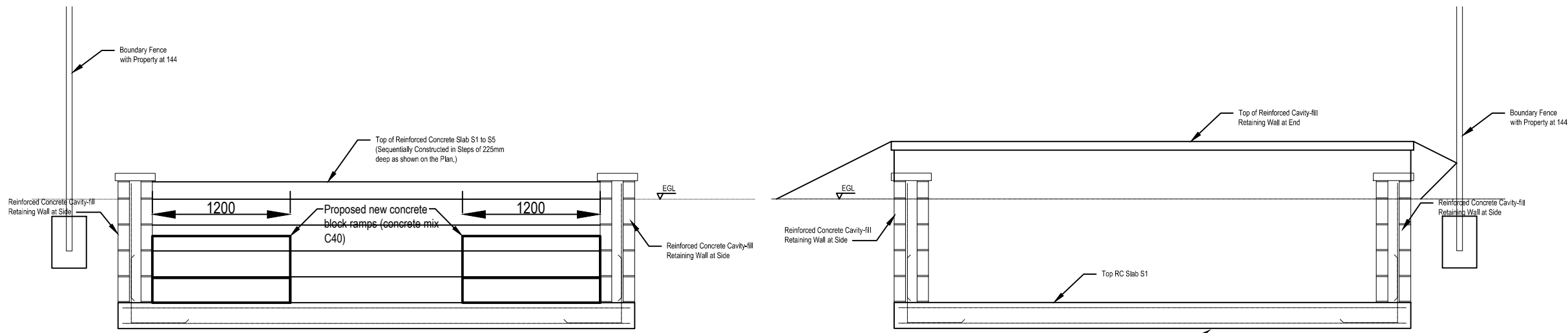

RAMP-DOWN RC SLAB SECTION F-F

RAMP-DOWN RC SLAB SECTION E-E

| Rev | Amendment                  | By   | Date      |
|-----|----------------------------|------|-----------|
| P1  | First Issue                | AA   | Jan. 2012 |
| P2  | RC Details added           | AA   | 23.01.12  |
| P3  | General Amendment          | AA   | 26.01.12  |
| P4  | Concrete block ramps added | B.E. | 08.07.13  |

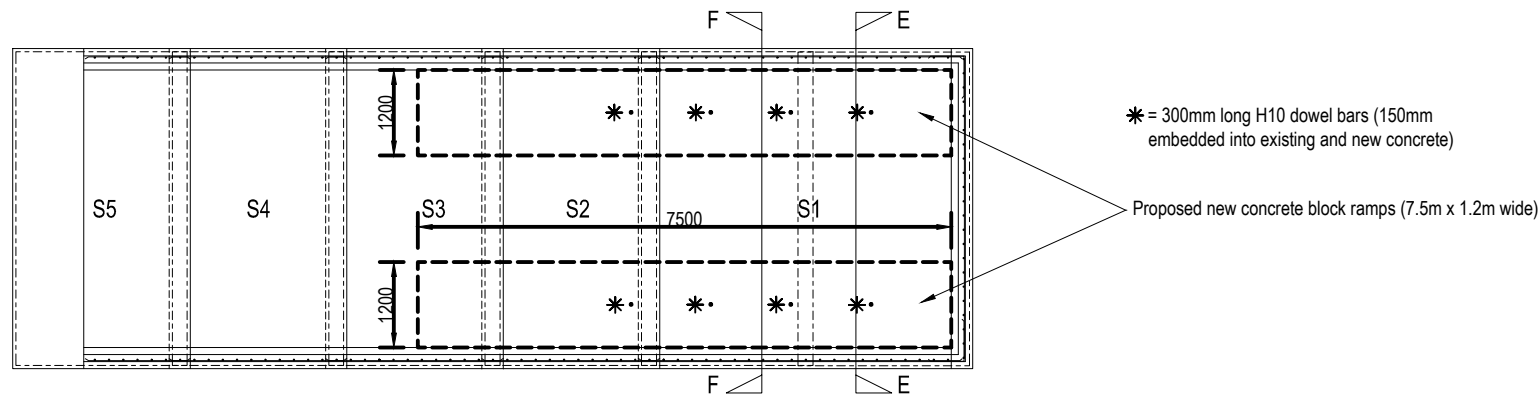

RAMPING DOWN RC SLAB & REINFORCED CAVITY-FILL RETAINING WALLS  
Showing sequential construction Steps of S1, S2, S3, S4 & S5 (Any of next step slab is cast at least three days after the one before)



Suite 116, Milton Keynes Business Centre, Foxhunter Drive,  
Linford Wood, Milton Keynes, MK14 6GD.  
t:01908 688955 f:01908 410333 www.cistec.net e:info@cistec.net

Client

MK PDR Spare Ltd

Drawing

Reinforced Concrete  
Ramping-down Slab With  
Typical Sections & Details

Project

146 Newport Road, New Bradwell, Milton Keynes MK13 0AA

Scale

Date Jan. 2012

Approved AA

Drawing no.

1116 - 302 P4

© The enclosed drawing and design remain the copyright of CISTEC Design LLP unless or until agreement is made in writing. This information may not be copied, distributed or otherwise used without prior written consent.

STATUS: PRELIMINARY