

CDM Regulations

Denotes a significant Hazard or difficult to manage procedure. Please refer to Designer Hazard Register for further information regarding mitigation of hazards

General Notes

Do not scale off this drawing unless a scale bar is provided.

Any ambiguities, omissions and errors on this drawing should be notified immediately to the Architect before the commencement of works on site.

All dimensions are in millimetres unless otherwise stated.

All dimensions, unless otherwise indicated, are to the face of unfinished block walls or to the rough timber face of stud partitions.

All dimensions are to be checked on site. Any discrepancies are to be notified immediately to the Architect before the commencement of works on site.

All levels are in meters unless otherwise stated.

This drawing is to be read in conjunction with all other relevant drawings and specifications for this project.

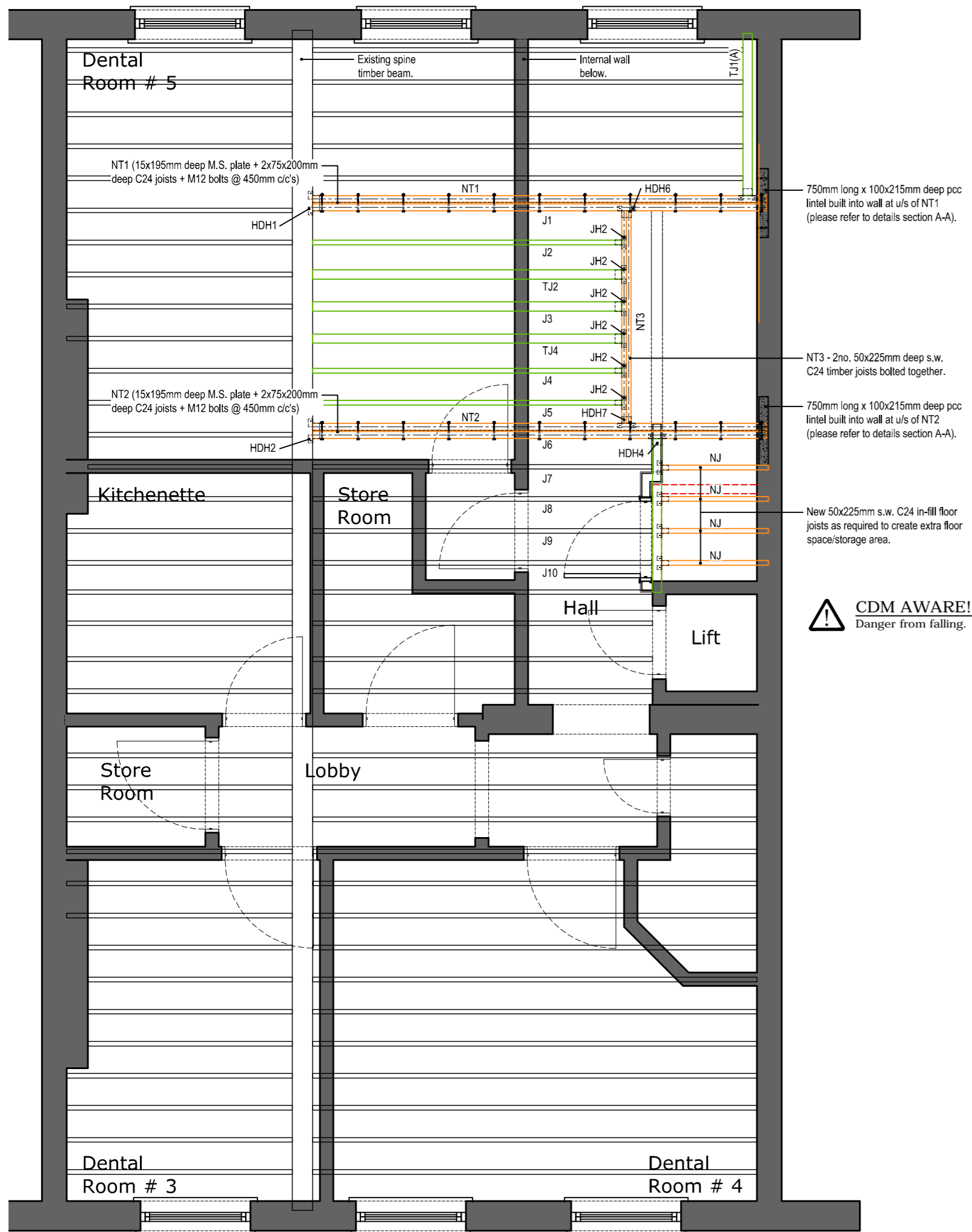

CDM AWARE!
Danger from falling.

Rev	Description	By	Date
P1	First issue.	swf	21.02.12

Sequence of Works

Stage 3

1. Install new double joists trimmer **NT3** between new trimmers **NT1** & **NT2**.
2. Install joists hangers **JH2** to existing cut floor joists at connection with new trimmer **NT3**.
3. Remove temporary trimmer (**TT**).
4. Install new floor joists (**NJ**) as required to create new floor space/storage.

JH2 - Simpson Strong Ties Adjustable Hangers ref.JHA

Key

- Existing timber to be removed. (Red dashed line)
- Existing timber to remain/be altered. (Green solid line)
- Proposed new timber. (Orange solid line)
- Temporary timbers. (Blue solid line)

Second Floor Plan (showing structure above) - alterations Stage 3

Scale 1:50

Client	Vanilla Pod
Project	Alterations & Roof Extension 35 Devonshire Place, London.
Job	Working Drawings

Drawing Title	Plans - Proposed Second Floor Showing structure above - stage 3		
Scale	1:50 @ A2	Drawn	SWF
Date	21.02.12	Checked	AA
Project No./Discipline	1076-	Drawing No.	206
		Revision	P1

DRAWING STATUS: PRELIMINARY - subject to building control approval