

First Floor Plan

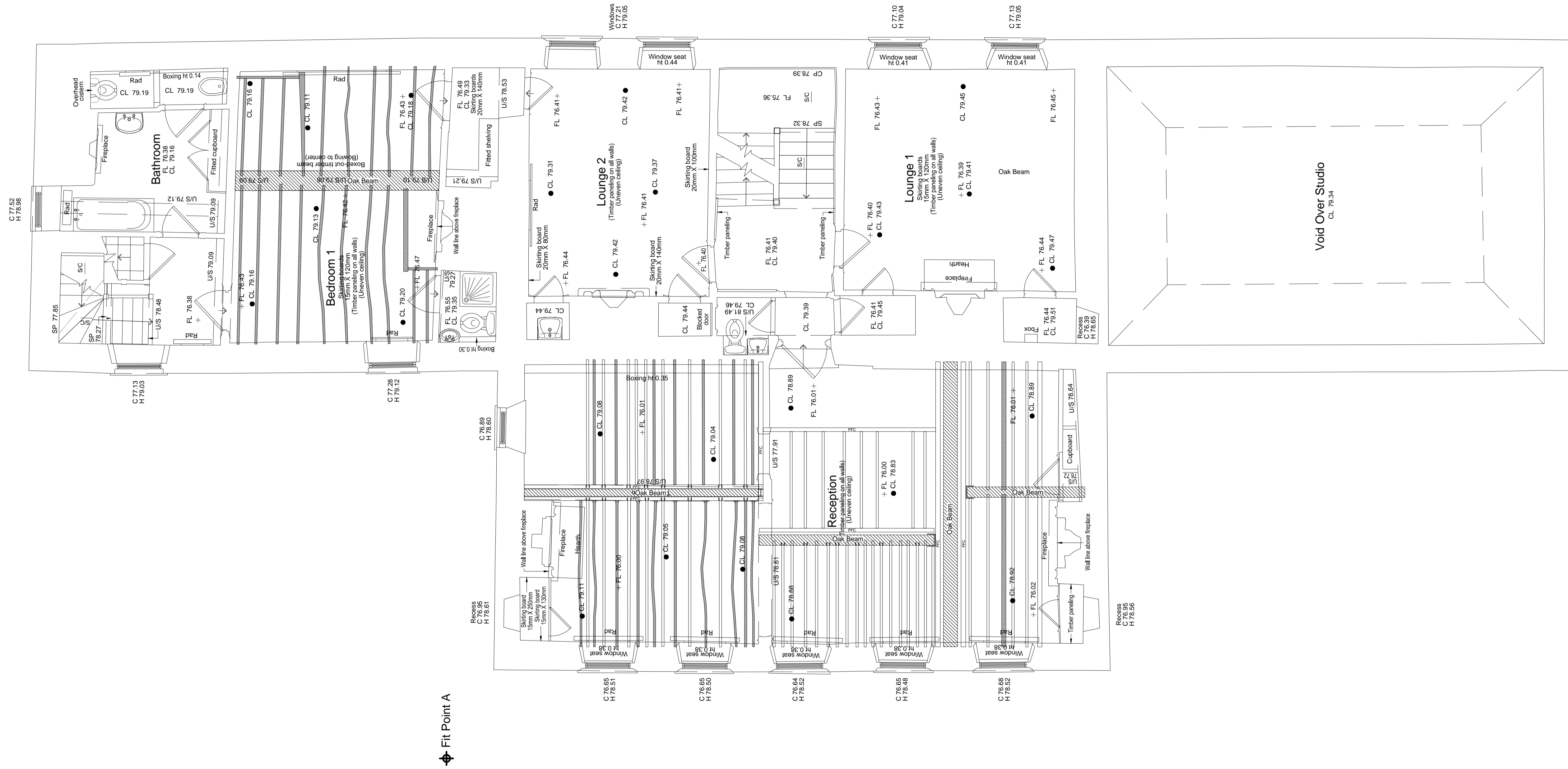

Fit Point A

Fit Point B

Rev	Amendment	By	Date
P1	First Issue	B.E.	20.05.13



Suite 121, Milton Keynes Business Centre, Foxhunter Drive,
 Linford Wood, Milton Keynes, MK14 6GD.
 T:01908 686855 F:01908 410333 www.cistec.net e:info@cistec.net

Client

Mr & Mrs P. Winkleman

Drawing
STRUCTURAL ENGINEERING
 First Floor Plan

Project
 Great Linford Manor, High Street, Great Linford, MK14 5AX

Scale: 1:10 @ A1 Date: 20.05.13 Approved: AA

Drawing no. **1229**

© The enclosed drawing and design remains the copyright of CISTEC Design LLP unless or until agreement is made in writing. This information may not be copied, distributed or changed in any form without prior written consent.

STATUS: PRELIMINARY