

Half Battered Kerb Restraint (HB2)

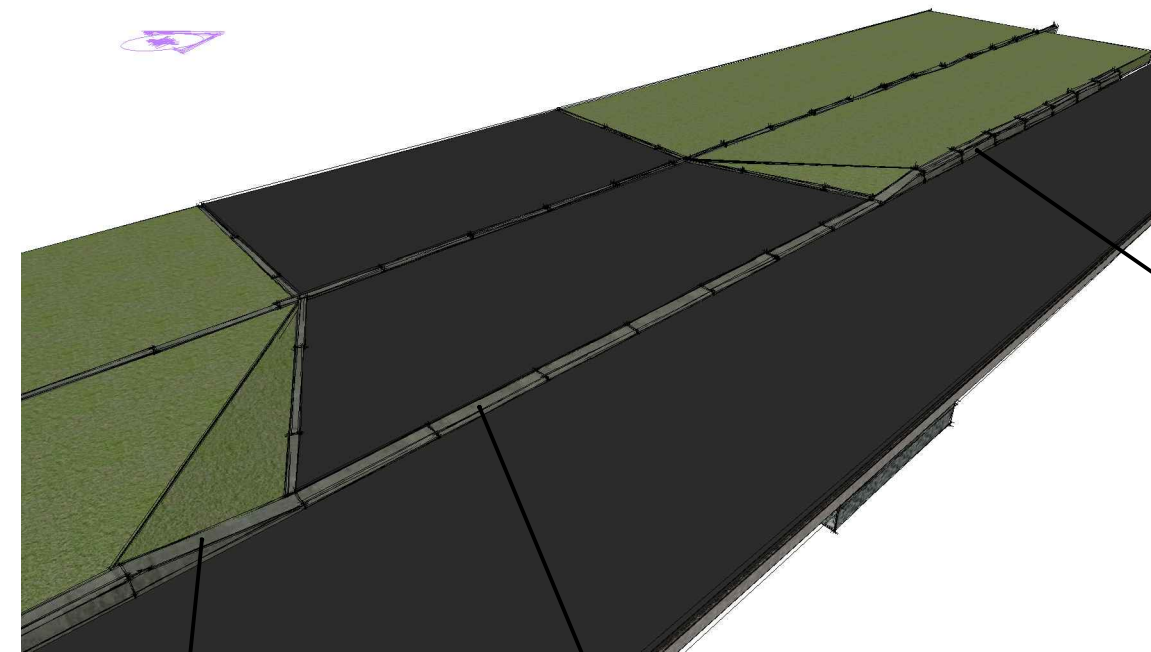

Transition kerb (DR1).

Bullnose pre-cast concrete kerb (BN4).

Notes

Half battered pre-cast concrete kerb (HB2).

Rev	Description	By	Date
P1	First issue.	MW	22.11.12

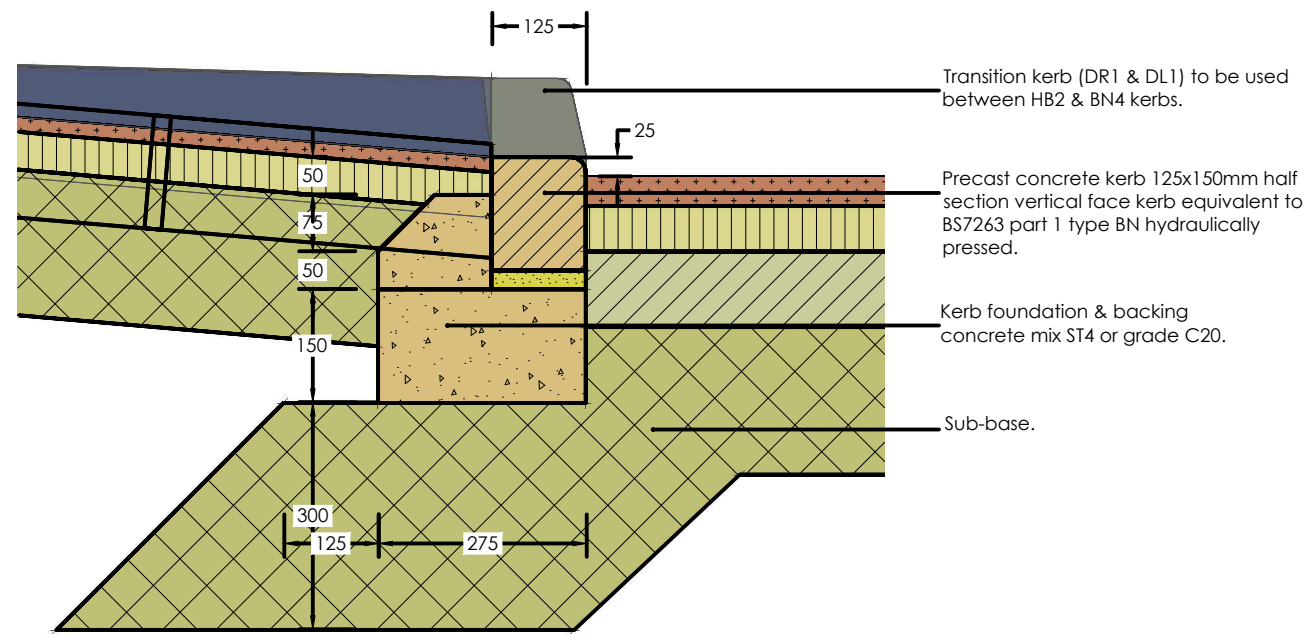

Bullnose Crossover Kerb (BN4)

Pre-cast concrete edgings to form spalys within grass/verge areas at to delineate highway boundaries.

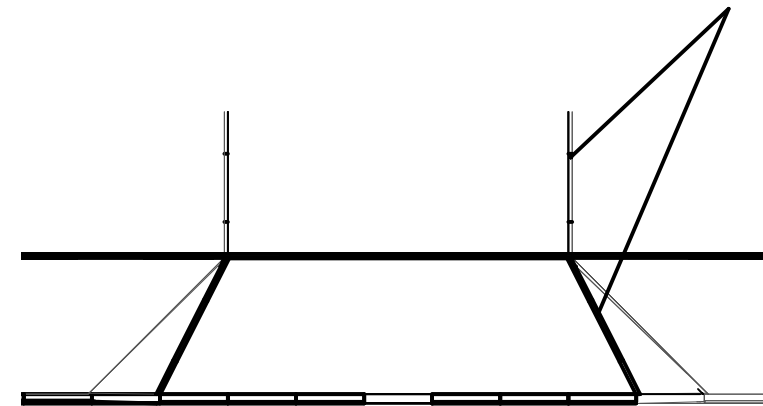

Client

SUN
CONTRACTORS LTD
 258 Belsize Rd, London, NW6 4BT
 T.020 7316 1850 F.020 7316 1892
 Email: info@suncontractors.co.uk

Project
MKMA
 Coffee Hall, Milton Keynes.

Job
Highway Construction Details

Drawing Title
**Kerb Restraints
 HB2 & BN4 (blacktop)**

Scale	1:10	Drawn	GS
Date	03.09.07	Checked	
Project No./Discipline	Drawing No.	Revision	
1127-SD-HW-	11	P1	

DRAWING STATUS: PRELIMINARY

D:\Citect\1127E_MKMA\Coffee Hall\Milton Keynes - Mohammed Agel\Civil Engineering\Drawings\1127-SD-HW-11P1 - Standard Half Battered & Dropped Kerbs.dwg... 22/11/2012 09:59:20, ISO Titled AS (20,00 x 297,00 MM), 1:1