

**PRIVATE DRAINAGE**

- INSPECTION CHAMBERS**  
Less than 0.6m depth Read in conjunction with Standard Drainage Details.
- INSPECTION CHAMBERS**  
0.6m to 1.2m OR restricted access >1.2m (ASD3a) Read in conjunction with Standard Drainage Details.
- INSPECTION CHAMBERS**  
1.2m to 1.5m depth Read in conjunction with Standard Drainage Details.
- YARD GULLY**  
Trapped and roddable with 100mm dia. outlet.
- ACU**  
Drainage Channel. Trapped and roddable with 100mm dia. outlet.
- DC**  
PCC Dished Channel see detail on drawing #1116/1.

**REGRADE**

- RETAINING WALL**  
to S.E details.
- WALLS TO BE TANKED**  
150MM above ground level.
- UNDERBUILD**  
Exposed brickwork below normal 150mm below gpc.
- LOW RETAINING**  
slab on edge\* (max 0.3M) or gravel boards below fences (max 0.6M).
- AMBULANT STEPS**  
0.3M going 0.15M max rise.
- LEVEL THRESHOLD 1.2Msq. (min)**  
Level area with flush threshold.
- PROPOSED GRADIENT**  
Normal gradients not requiring banking or handrails.
- PROPOSED BANKING**  
With gradient.
- ORIGINAL LEVELS**  
(Levels prior to construction work).
- PROPOSED FINISHED LEVELS**  
(Levels proposed by Abnic).
- ACTUAL FINISHED LEVELS**  
(Levels after construction work).

**FENCING**

- EXISTING FENCE.**
- PROPOSED ACOUSTIC FENCE.**

- General Engineering Notes**
- This drawing shall be read in conjunction with all other relevant architects and engineers drawings.
  - It is the contractors responsibility to locate existing services where they may be affected by proposed works.
  - Design and construction details for all new or amended vehicle crossings to be approved by Herts Highways.
  - Where private drives fall towards adoptable highways, surface water run off shall be prevented from draining onto public areas with the use of a ditched channel and yard gully or proprietary drainage channel located at the rear of adoptable footpath.
  - Where private drives fall towards private garages, a drainage channel with internal fall shall be used to prevent flooding of garages. Channels to be Acou or similar approved
  - All private drainage to be 100mm dia. with minimum falls of 1:80 unless noted otherwise.
  - All adoptable drainage shall be either clay, to BS65 with either socket or sleeve joint or concrete to BS5911 part 1.
  - All domestic drainage beneath adoptable highways shall be vitrified clay extra strength and with concrete bed and surround should cover be less than 1200mm.
  - Any discrepancies, ambiguities or anomalies in the information provided on this or any of the engineering drawings package must be reported prior to work proceeding.
  - The last or disconnecting length of any building drainage system which connects to adoptable or adopted sewers shall be 150mm dia.
  - Block paving in adoptable carriageways to be ??? in colour and laid to 45 deg. herringbone pattern.
  - Any service strips and areas within the road junctions (non footway or carriageway) shall be grassed.
  - Gullies shall not be placed within the limits of dropped crossings used by pedestrians or vehicles unless required for a low point.
  - Stop cock and meter covers shall not be located within vehicular crossing construction.

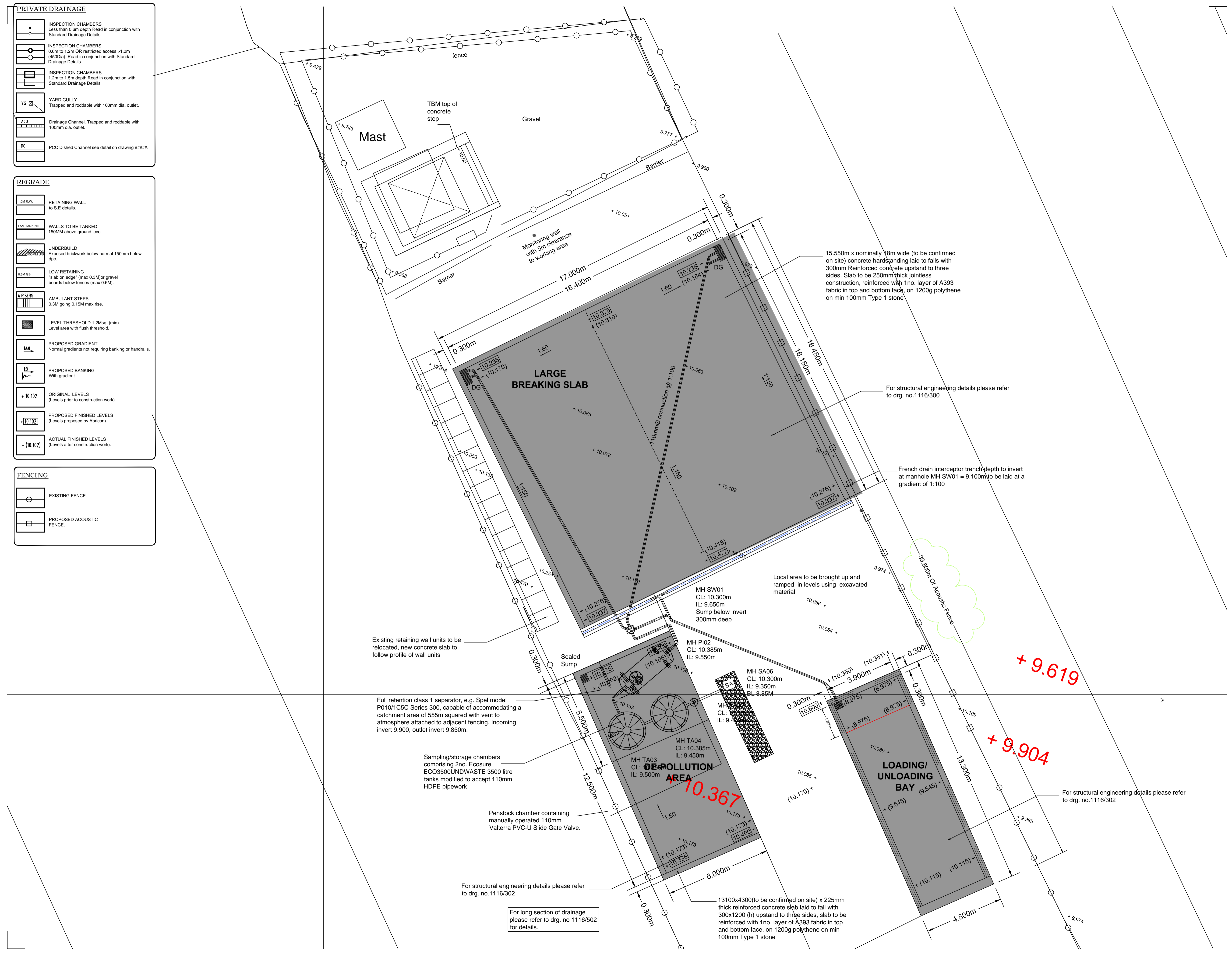

Rev	Amendment	By	Date
P1	First issue.	SWF	19.01.12
P2	Petrol interceptor, sampling tanks and penstock chamber relocated due to existing tank/concrete slab.	SWF	26.01.12
P3	Slab sizes corrected. Petrol interceptor repositioned due to inlet/outlet positions.	SWF	31.01.12
P4	As-built levels added.	SWF	14.03.12
P5	Acoustic fence added.	B.E.	28.02.13
P6	Extent of acoustic fence revised.	SWF	26.04.13
P7	Further as-built levels added.	B.E.	03.07.13

**CISTEC**  
 CHARTERED CIVIL & STRUCTURAL ENGINEERING CONSULTANTS  
 Suite 116, Milton Keynes Business Centre, Foxhunter Drive,  
 Linford Wood, Milton Keynes, MK14 6GD.  
 T: 01908 686855 F: 01908 410333 www.cistec.net e: info@cistec.net

Client: **MK PDR Spares Ltd**

Drawing: **Engineering Layout**

Project: **146 Newport Road, New Bradwell, MK13 0AA**

Scale: 1:100 @ A1 Date: 19.01.12 Approved

Drawing no. **1116/501 P7**

STATUS: PRELIMINARY

© The enclosed drawing and design remains the copyright of CISTEC Design LLP unless or until agreement is made in writing. This information may not be copied, distributed or changed in any form without prior written consent.