

NOTES

CDM REGULATIONS

NO DRAWING OR OTHER DESIGN INFORMATION SHOULD BE READ WITHOUT REFERENCE TO THE HEALTH AND SAFETY PLAN.

- THIS DRAWING IS TO BE READ IN CONJUNCTION WITH ALL RELEVANT ARCHITECTS, ENGINEERS AND SPECIALIST SUBCONTRACTORS DRAWINGS AND SPECIFICATIONS. ANY DISCREPANCIES BETWEEN THESE DRAWINGS ARE TO BE REPORTED IMMEDIATELY.
- CONCRETE TO BE DESIGNATED MIX RC35 STRENGTH CLASS C28/35. MAXIMUM AGGREGATE SIZE 20mm. ALL TO BS8500-2 2006. BLINDING CONCRETE TO BE DESIGNATED MIX GEN 2. STRENGTH CLASS C12/15 TO BS8500-2 2002.
- 50mm BLINDING CONCRETE TO BE PLACED UNDER ALL GROUND BEAMS AND PILE CAPS.
- ALL PILE CAPS AND GROUND BEAMS TO BE SYMMETRICAL ABOUT GRID LINES (OR CENTRE LINES) UNLESS NOTED OTHERWISE ON PLAN.
- TOPS OF ALL PILE CAPS AND GROUND BEAMS AROUND PERIMETER TO BE AT +2.765 UNLESS NOTED OTHERWISE ON PLAN. TOPS OF INTERNAL GROUND BEAMS SUPPORTING GROUND FLOOR SLAB TO BE AT 3.190 UNLESS OTHERWISE NOTED ON PLAN.

LEGEND

- 1B2 450x600 GROUND BEAM REFERENCE AND SIZE (DxW)
- PC1 PILE CAP REFERENCE (REFER TO SCHEDULE BELOW)

PILE CAP SCHEDULE

| PILE CAP REF. | No. OF | SIZE (LxWxD) | LEVELS (U.N.O. ON PLAN) |
|---------------|--------|---------------|--|
| PC1 | 20 | 2250x750x750 | (TOP LEVEL) TL: 2.765 UL: 2.015 (UNDERSIDE LEVEL) |
| PC2 | 9 | 2250x1000x750 | TL: 2.765 UL: 2.015 |
| PC3 | 8 | 900x900x750 | TL: 2.765 UL: 2.015 |

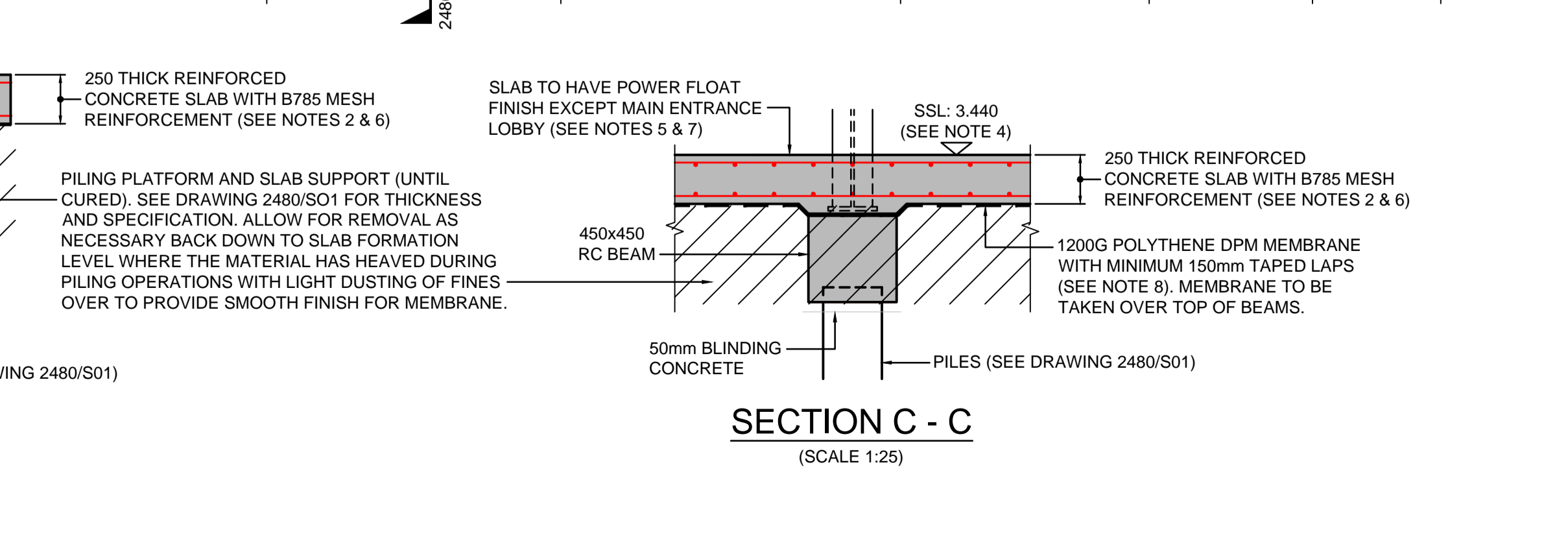
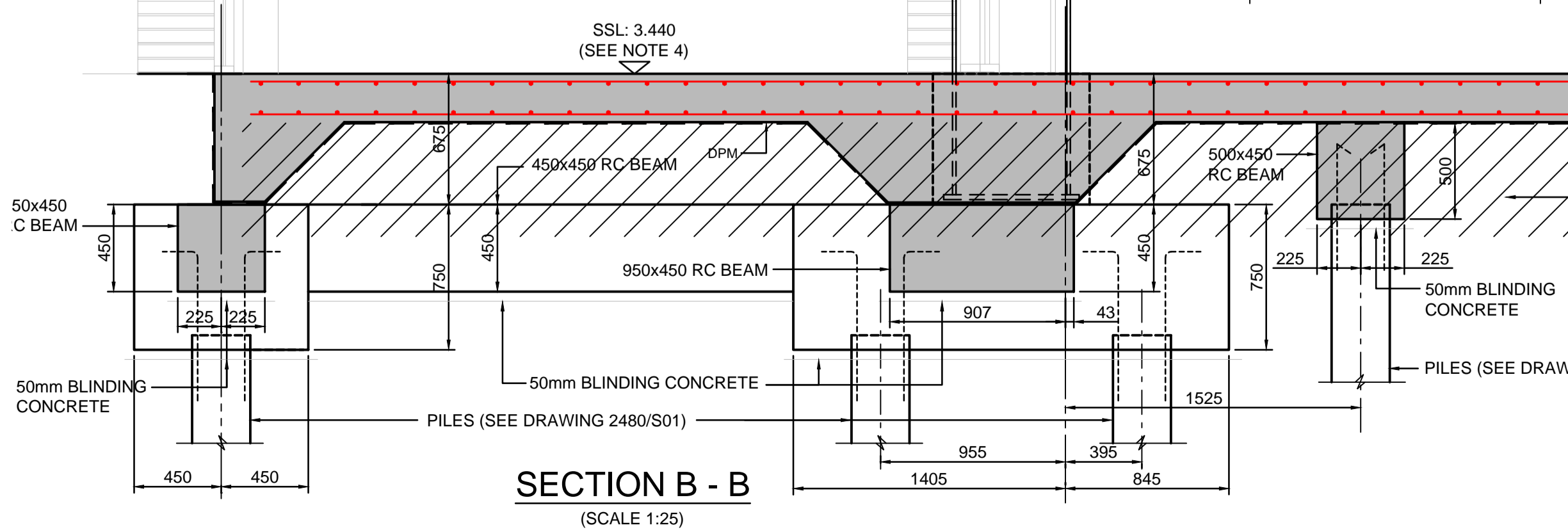

CONSTRUCTION

| Revision | Date | Description |
|----------|----------|--|
| C2 | 01/06/09 | POSITION OF BEAMS SUPPORTING AMENITY BLOCK INTERNAL STANCHIONS FINALISED |
| C1 | 13/05/09 | CONSTRUCTION ISSUE |
| T2 | 24/10/08 | UPDATED |
| T1 | 16/10/08 | TENDER ISSUE |
| P1 | 11/09/08 | PRELIMINARY ISSUE |

CISTEC
 CHARTERED CIVIL & STRUCTURAL ENGINEERS
 Osborn House, 20 High Street South, Olney, Bucks. MK46 4AA.
 01234 240640 f.01234 240644 e.info@cistec.net

The Institution of Structural Engineers

WICKES WEST STREET, BOSTON
 Design: AA Drawn: SF
 Scale: 1:100 @ A1, 1:200 @ A3
 Date: 11th September 2008
GENERAL ARRANGEMENT OF FOUNDATIONS
 Drg.No: 2480/002 Rev: C2